



Ybl Miklós Faculty of Architecture And Civil Engineering, Community and Urban Planning The Budapest Project, »City 4.0: Smart, Green and SUB-ECO« Prof. Holm Kleinmann, emer.

Members of the creative group:



- URBAN GREEN ●
- FOREST GREEN ●
- FARMIN GREEN ●
- RECREATIONAL ●



URBAN CONCEPT

The Main idea about the agricultural urban planning is the sustainability and going back to the nature. Therefore we tried to find a pure center with no cars. We made this ring road around the center to provide the accessibility to the



WORKSHOP II: URBAN AGRICULTURE

THIS DIAGRAM ILLUSTRATES WHAT I THOUGHT ABOUT URBAN AGRICULTURE DUE TO SOME FEATURES OF THE SITE I CAN SUMMERIZE THE CONCEPT AS AN MULTIPLE COMMUNITES ORDERED SEQUENTLY NEXT TO EACHOTHER TO GIVE A MEANING AS A WHOLE.

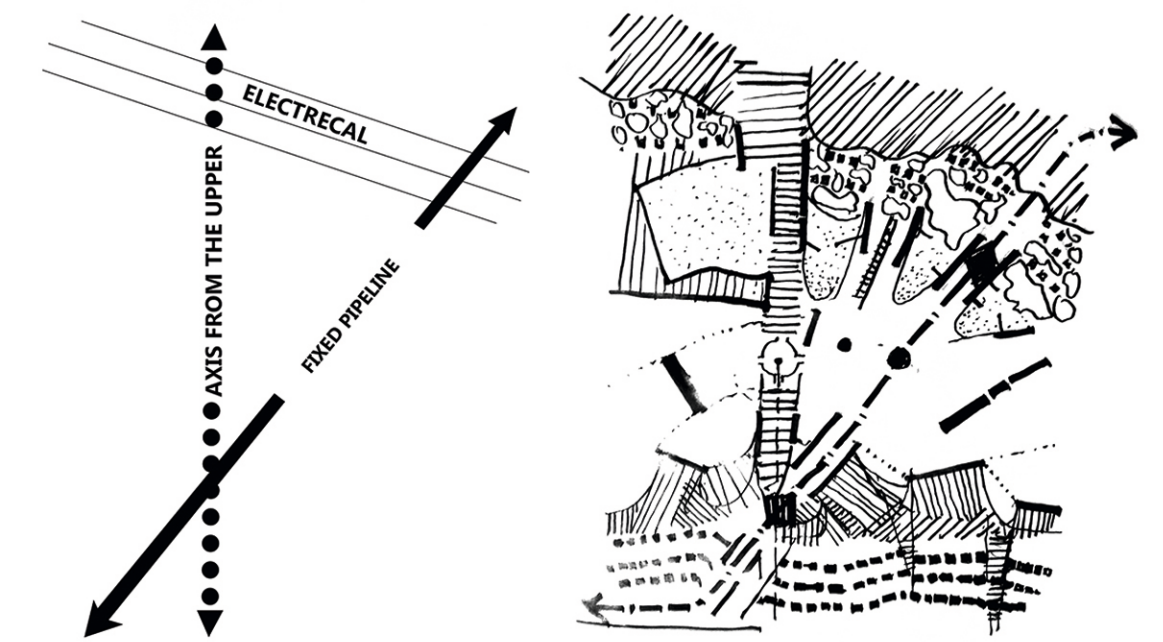

DESIGN ACORDING TO SITE ELEMENT

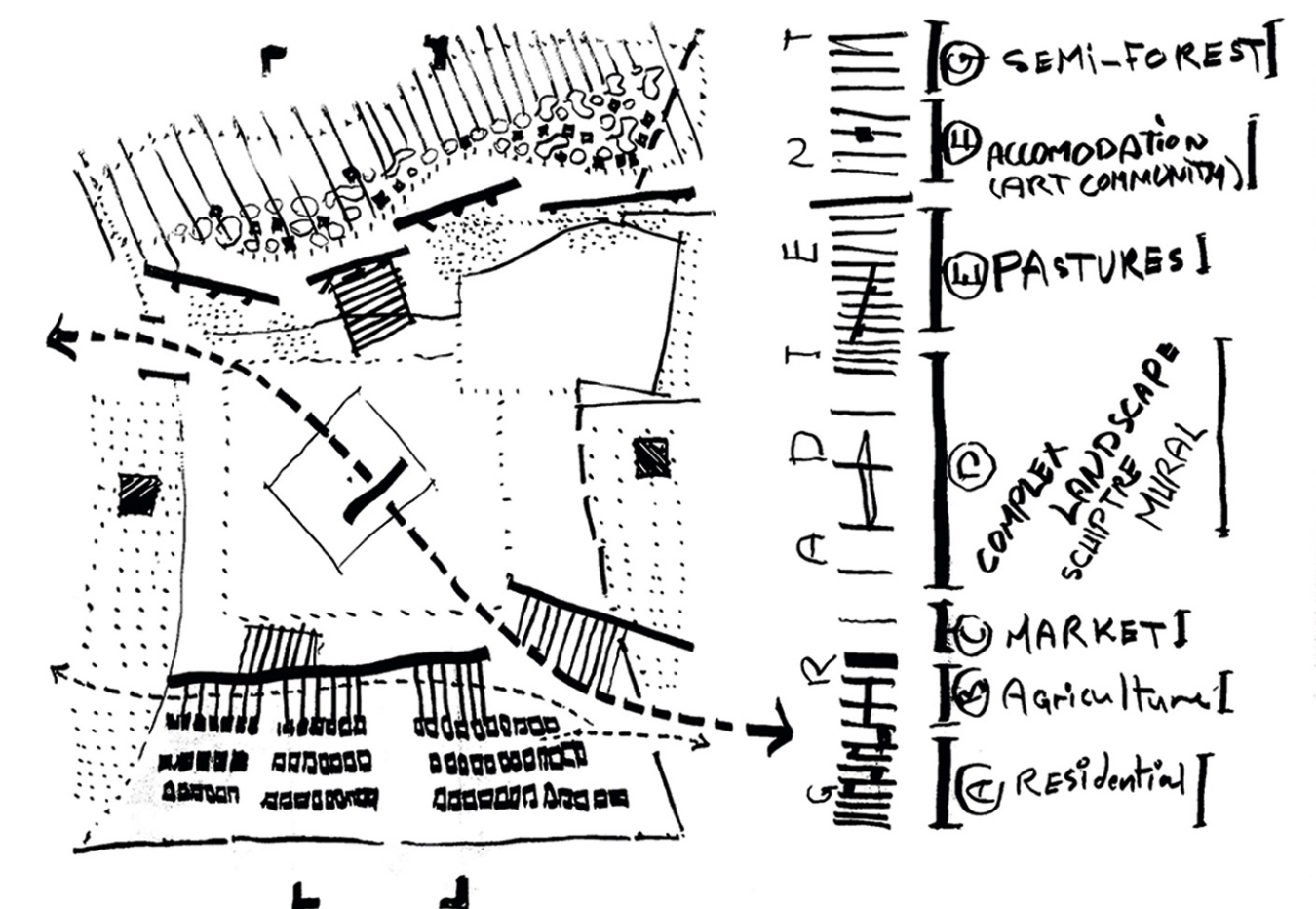

DESIGN ACORDING TO THE URBAN AGRICULTURE CONCEPT MODEL

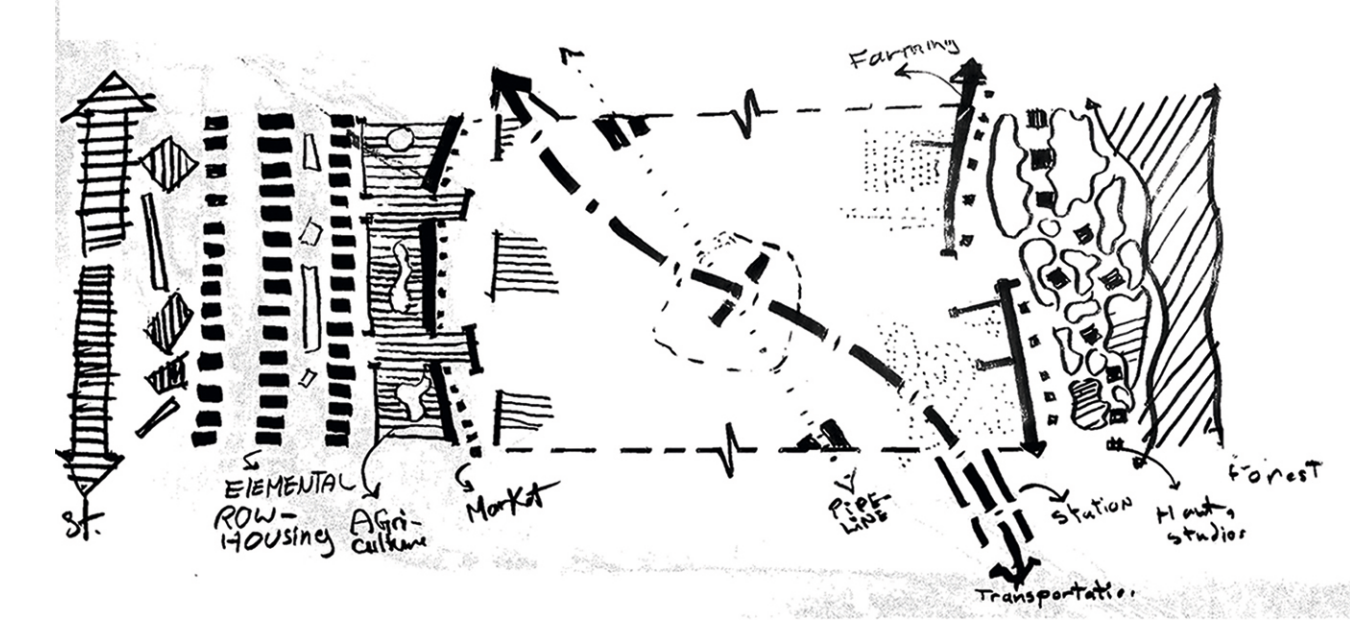

KEYWORDS

- | | |
|------------------------|-----------------------------|
| PHYSICAL FEATURES | FIZIKAI JELLEMZŐK |
| FUTURISTIC VISION | FUTURISZTIKUS VÍZIÓ |
| URBAN CONTEXT | VÁROSI KÖRNYEZET |
| THE CITY CHARACTER | A VÁROSI KARAKTER |
| ATMOSPHERES | HANGULATOK |
| OPEN | NYITOTT |
| COMMON | KÖZÖS |
| SOCIAL | TÁRSADALMI |
| DENSE & VARIOUS | SŰRŰ ÉS VÁLTOZATOS |
| ROMAN MODEL | RÓMAI MODEL |
| NATURAL VS. ARTIFICIAL | TERMÉSZETES VS. MESTERSÉGES |
| VOID(S) OF NATURE | TERMÉSZETES ÜRESSÉG(EK) |

URBAN CONCEPT

The Main idea about the agricultural urban planning is the sustainability and going back to the nature. Therefore we tried to find a pure center with no cars. We made this ring road around the center to provide the accessibility to the

1

DETAILED FLOOR PLAN

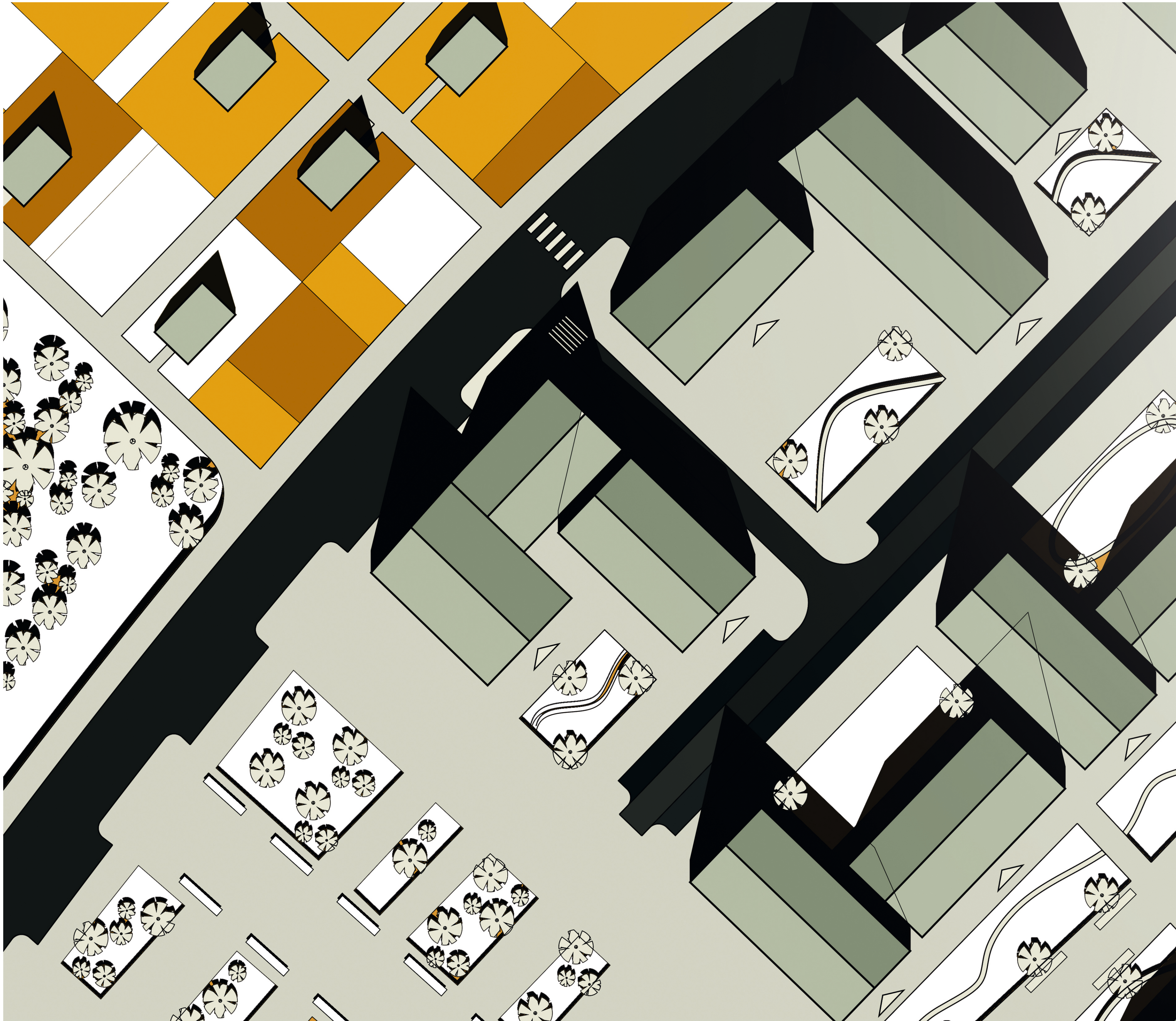

BUILDING MASS



FUNCTIONS

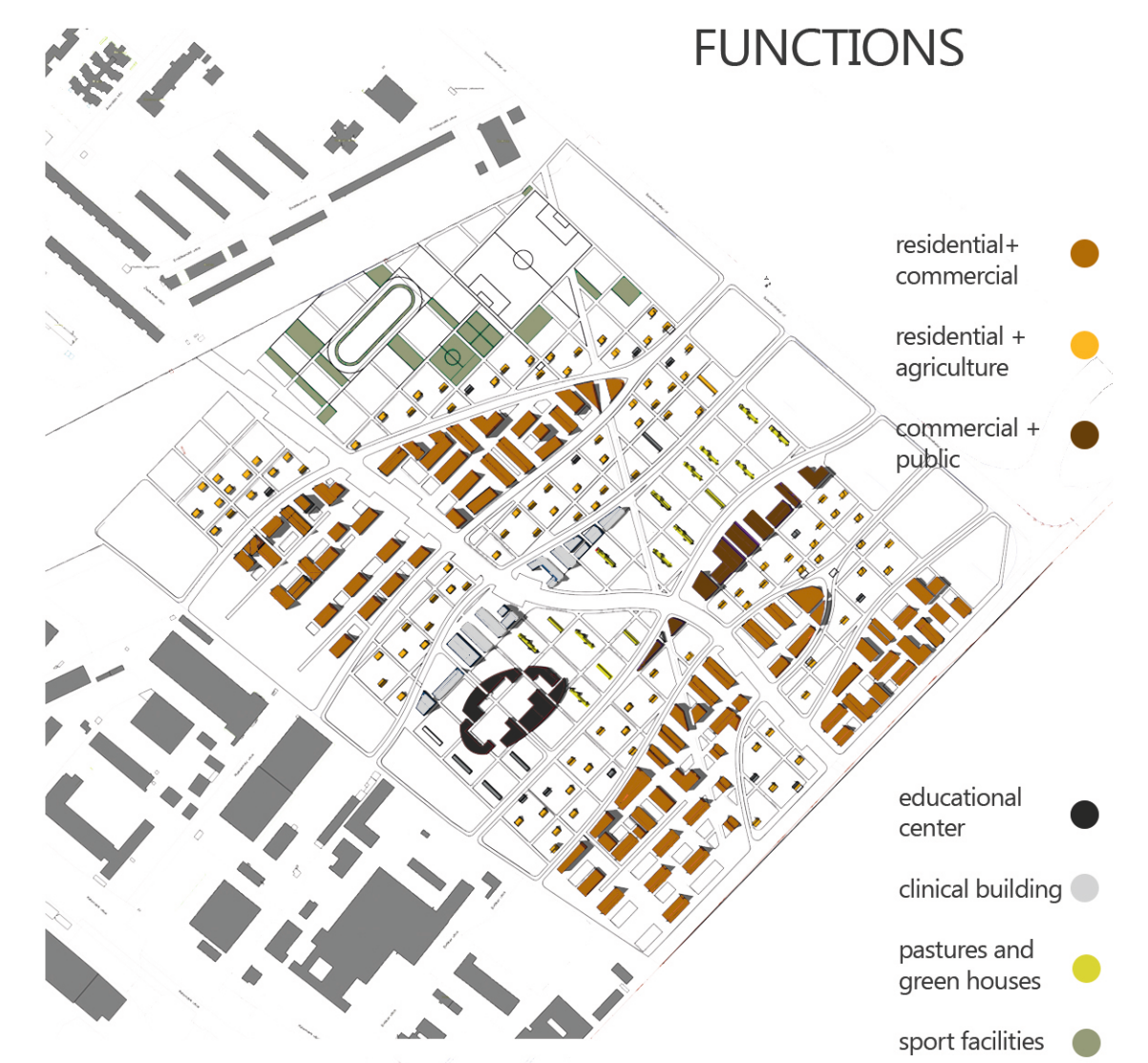

BUILDING HEIGHTS

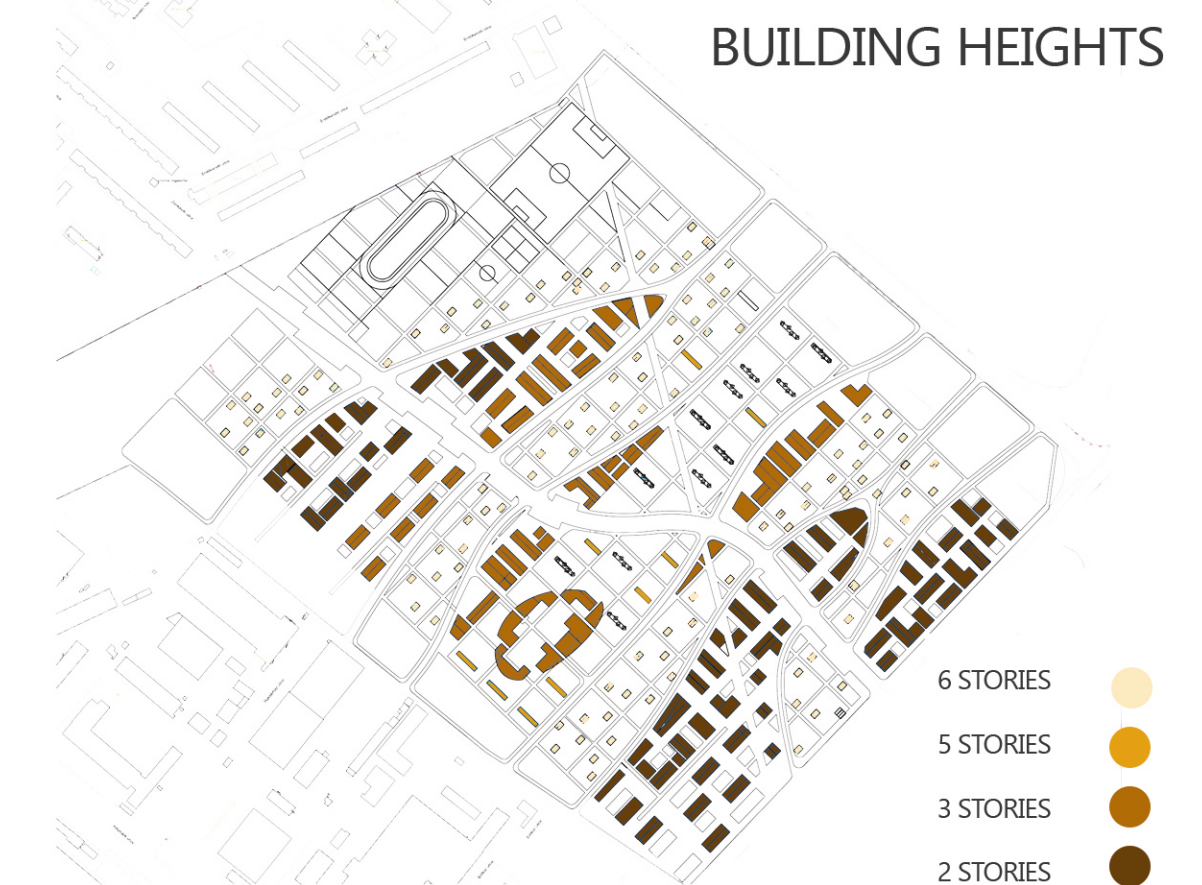

PERSPECTIVE



USE OF PUBLIC SPACES

